



Installation instructions for MS Fasteners

Example: MS 45

Required tooling:

- * “T” square
- * Ruler, for belt alignment
- * Belt marking pen
- * Battery powered screwdriver (14 V or better)
- * Drive bit, PZ2
- * Callipers to measure thickness of belt (for proper screw length)
- * Utility knife

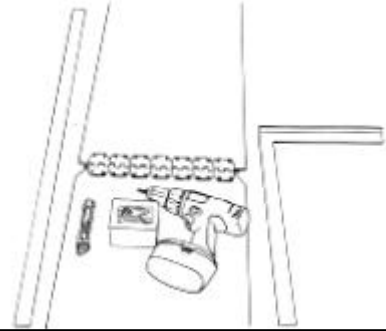

STEP #1

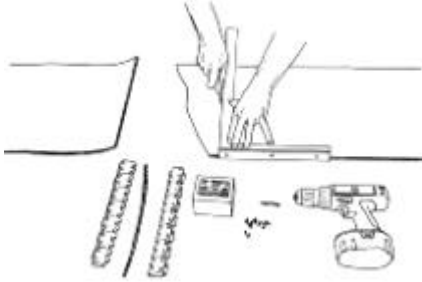

- 1) Cut the belt-edges square.
Check the belt thickness in order to ensure the right choice of screws. (See table on brochure)

STEP #2



- 2) Slide the fastener over the belt until it reaches the “belt stop” inside the fastener. Then, close it by hand, or with a plastic / rubber hammer.

STEP #3

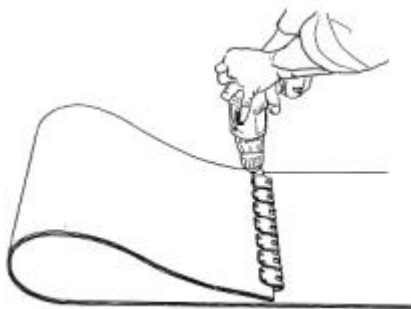

- 3) Determine the method of installation:
 - * Quick installation: install on top of belt.
 - * Leak resistant installation: install on bottom
 Start the first screw in the centre of the fastener, second and third screws far left and right ends. Hold your screwdriver at right angles to insure proper installation. (Some force is required). For best results, the nut on the bottom side (the inward facing protrusion in the bottom half of the fastener) must dig itself into the belt and the top plate should visibly compress the rubber of the top-cover.

STEP #4

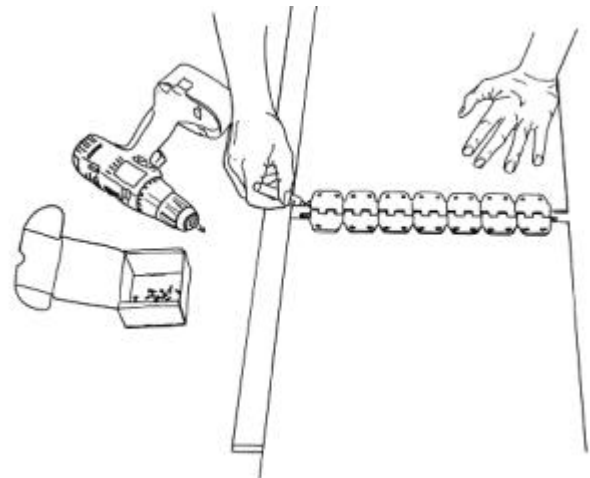

- 4) Place the second fastener half on the opposite side of the belt, make correct alignment and mark the position of the fastener.

STEP #5 & #6

Repeat step #3.

Relieve the corners of the belt with a knife.

